



HSB – där möjligheterna bor

# ENSPÄNNARGATAN

## 22, 24, 28

Hässelby, Stockholm

Kv. Ekotemplet 3

2 RoK 55 m<sup>2</sup>

Ighnr 2201, 2211, 2221, 2401,

2411, 2421, 2801, 2811,

2821

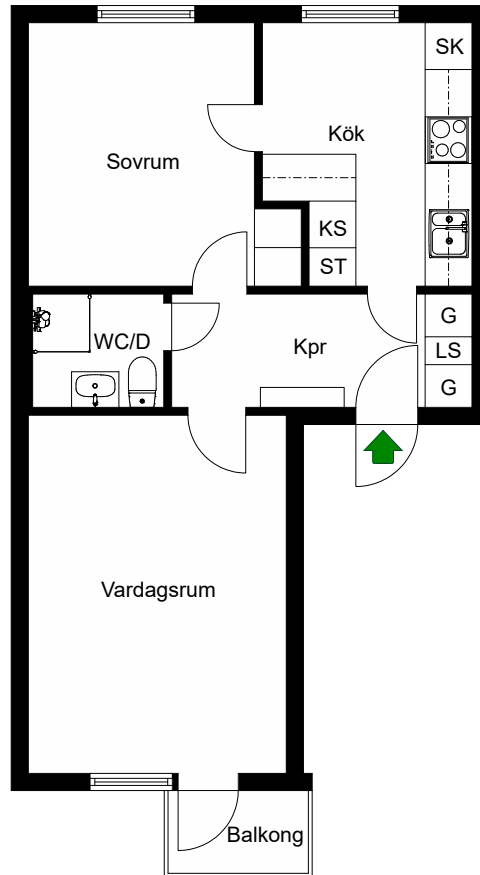

G = Garderob

└┘ = Dusch/Badkar

ST = Städskåp

KS = Kylskåp

SK = Skafferi

LS = Linneskåp

= Spis

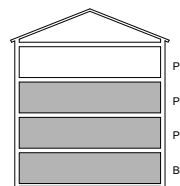
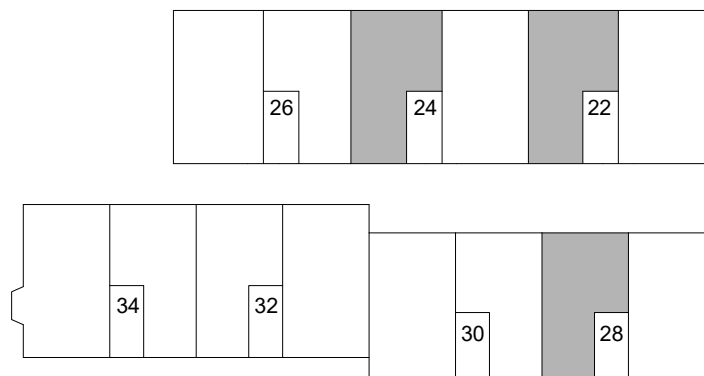

Avvikelser kan förekomma

2020-10-29



HSB – där möjligheterna bor

# ENSPÄNNARGATAN

## 22

Hässelby, Stockholm

Kv. Ekotemplet 3  
3 RoK 71 m<sup>2</sup>  
Ighnr 2202, 2212, 2222

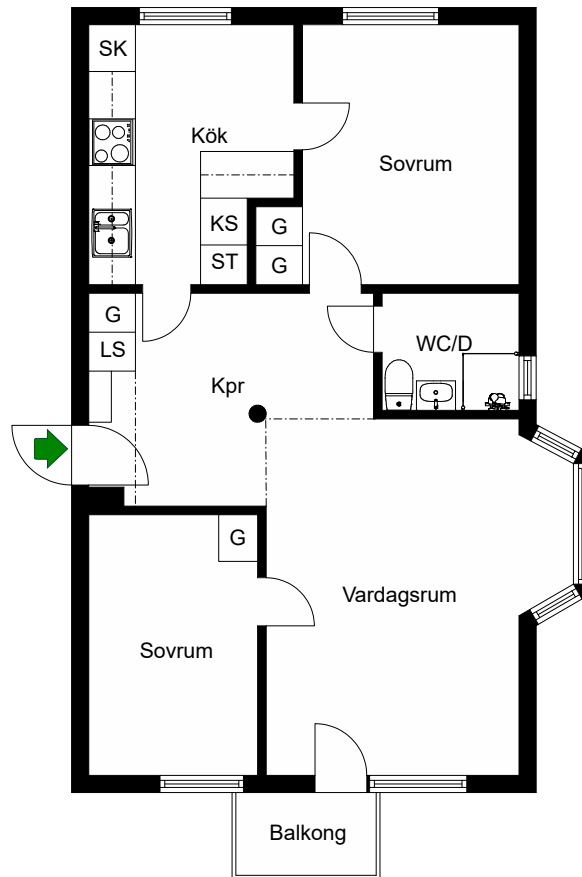

- G =Garderob
- ST =Städskåp
- KS =Kylskåp
- SK =Skafferi
- LS =Linneskåp
- ○  
○ =Spis
- =Dusch/Badkar

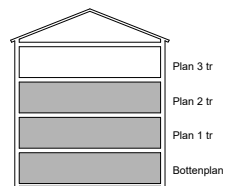
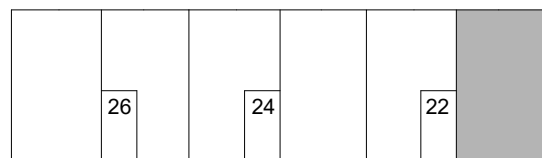

Avvikelser kan förekomma

2020-10-29



HSB – där möjligheterna bor

# ENSPÄNNARGATAN

## 26, 30, 34

Hässelby, Stockholm

Kv. Ekotemplet 3

2 RoK 55 m<sup>2</sup>

Ighnr 2602, 2612, 2622, 3002,

3012, 3022, 3402, 3412,

3422

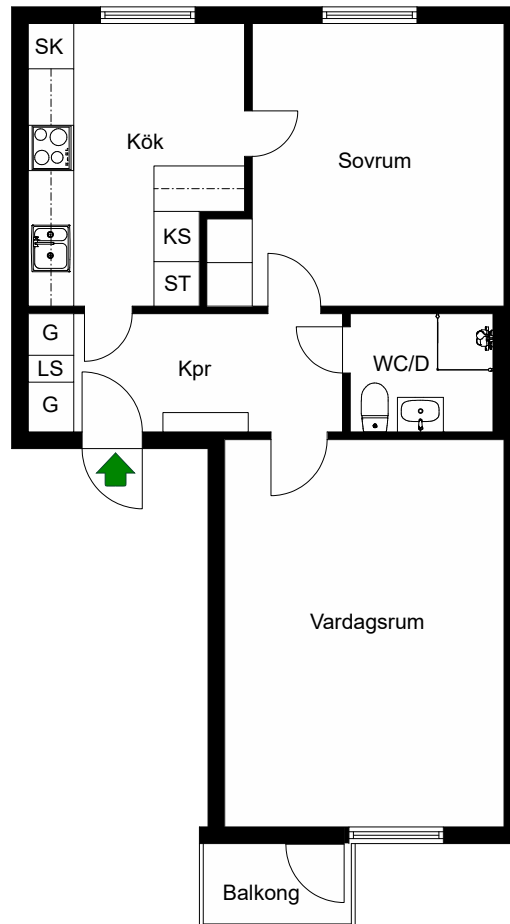

=Garderob	=Dusch/Badkar		
=Städsåp			
=Kylskåp			
=Skafferi			
=Linneskåp			
=Spis			

Avvikelser kan förekomma

2020-10-29



HSB – där möjligheterna bor

# ENSPÄNNARGATAN

## 24, 28, 32

Hässelby, Stockholm

Kv. Ekotemplet 3

3 RoK 69 m<sup>2</sup>

Ighnr 2402, 2412, 2422, 2802,

2812, 2822, 3202, 3212,

3222

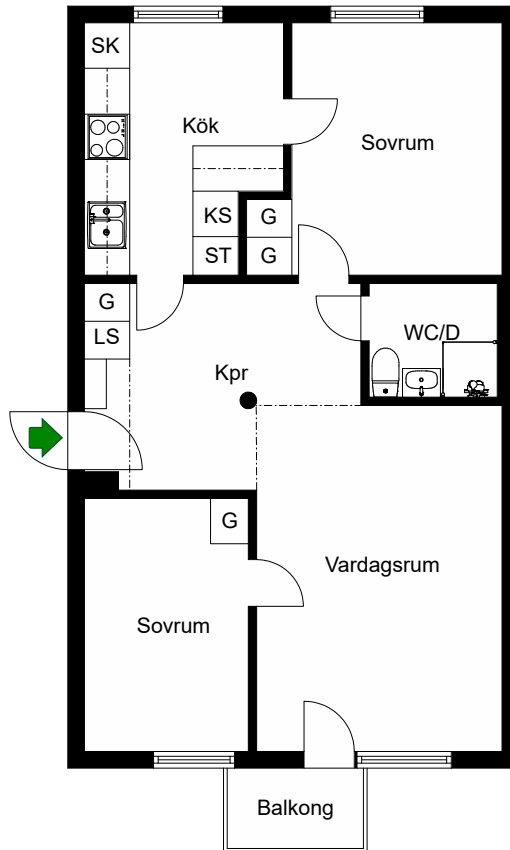

G = Garderob

└┘ = Dusch/Badkar

ST = Städsåp

KS = Kylskåp

SK = Skafteri

LS = Linneskåp

= Spis

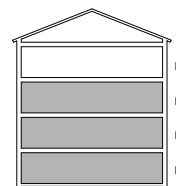
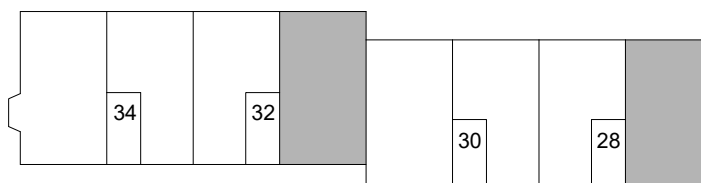
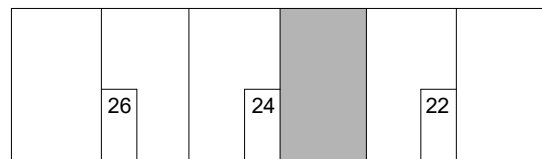

Avvikelser kan förekomma

2020-10-29



HSB – där möjligheterna bor

# ENSPÄNNARGATAN

## 26, 30

Hässelby, Stockholm

Kv. Ekotemplet 3  
3 RoK 69 m<sup>2</sup>  
Ighnr 2601, 2611, 2621,  
3001, 3011, 3021

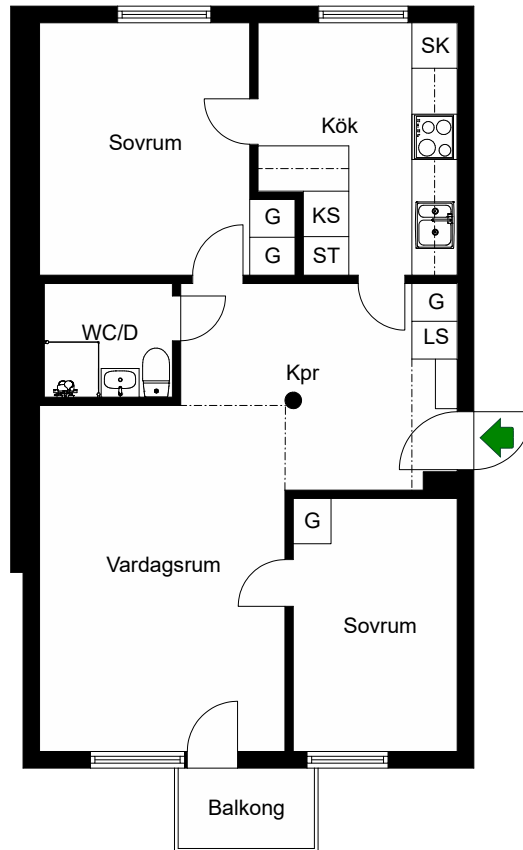

=Garderob	=Dusch/Badkar		
=Städsåp			
=Kylskåp			
=Skafferi			
=Linneskåp			
=Spis			

Avvikelser kan förekomma

2020-10-29



HSB – där möjligheterna bor

# ENSPÄNNARGATAN

## 32

Hässelby, Stockholm

Kv. Ekotemplet 3  
2 RoK 55 m<sup>2</sup>  
Ighnr 3201, 3211, 3221

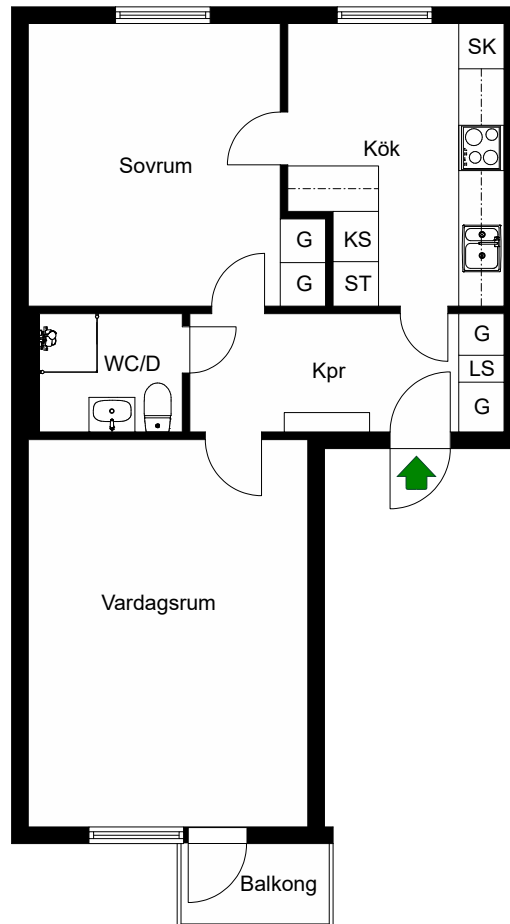

G = Garderob

= Dusch/Badkar

ST = Städskåp

KS = Kylskåp

SK = Skafferi

LS = Lanneskåp

= Spis

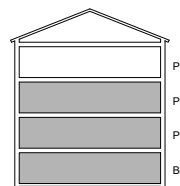
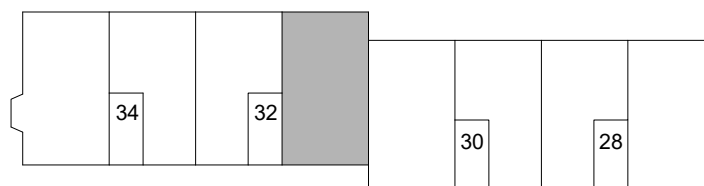

Avvikelser kan förekomma

2020-10-29



HSB – där möjligheterna bor

# ENSPÄNNARGATAN

## 34

Hässelby, Stockholm

Kv. Ekotemplet 3  
3 RoK 71 m<sup>2</sup>  
Ighnr 3401, 3411, 3421

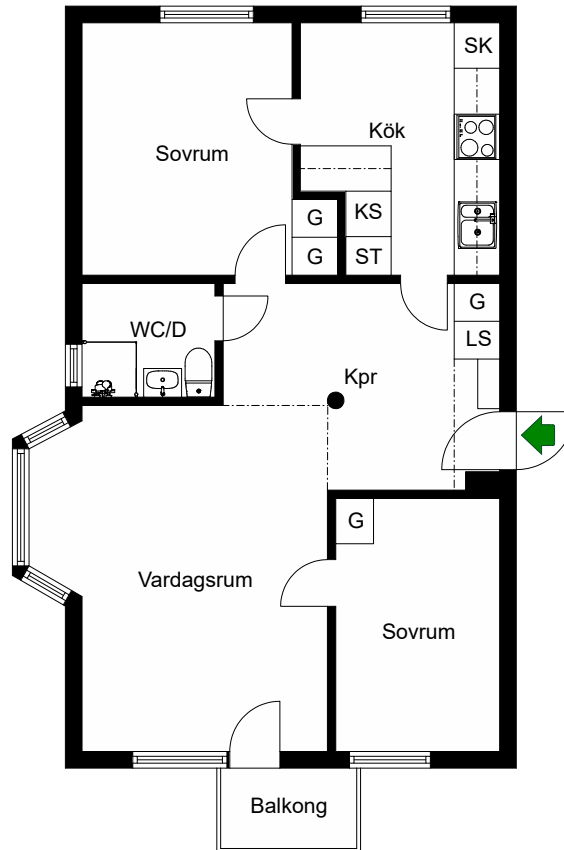

G = Garderob

[Symbol] = Dusch/Badkar

ST = Städsåp

KS = Kylskåp

SK = Skafferi

LS = Linneskåp

[Symbol] = Spis

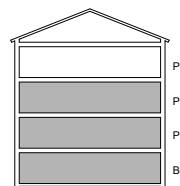
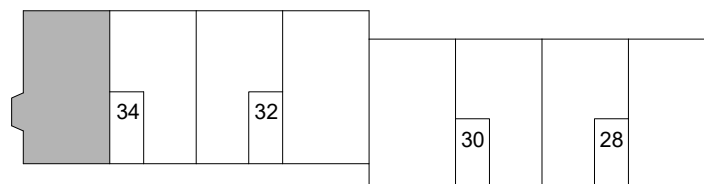

Avvikelser kan förekomma

2020-10-29



HSB – där möjligheterna bor

# ENSPÄNNARGATAN

## 36, 38

Hässelby, Stockholm

Kv. Ekotemplet 3

2 RoK 55 m<sup>2</sup>

Ighnr 3601, 3611, 3621,

3801, 3811, 3821

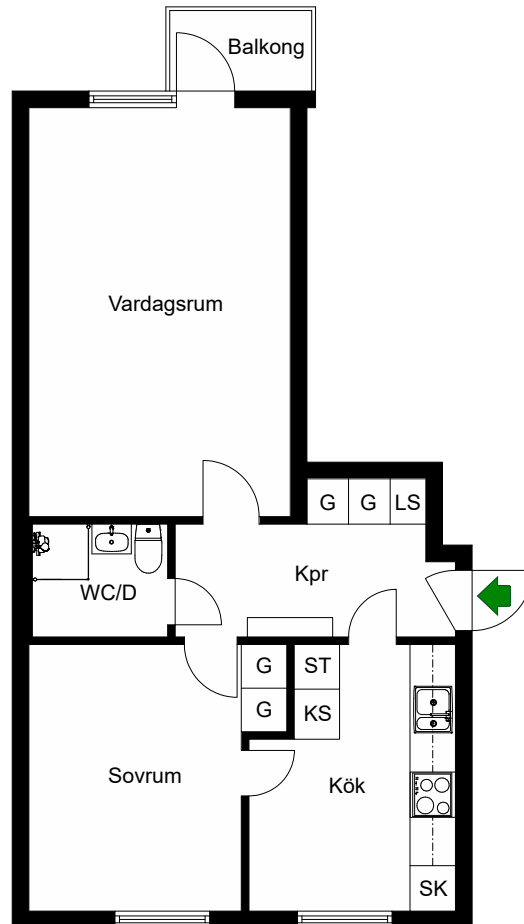

G =Garderob

=Dusch/Badkar

ST =Städsåp

KS =Kylskåp

SK =Skafferi

LS =Linneskåp

=Spis

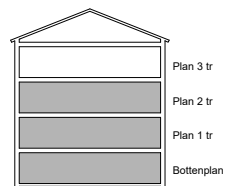
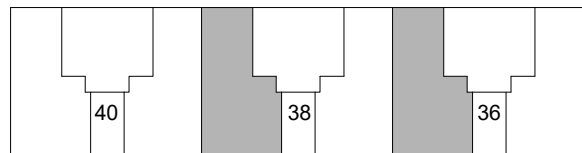

Avvikelser kan förekomma

2020-10-29





HSB – där möjligheterna bor

# ENSPÄNNARGATAN

## 36, 38, 40, 42, 44, 46

Hässelby, Stockholm

Kv. Ekotemplet 3

1 RoK 40 m<sup>2</sup>

Ighnr 3602, 3612, 3622, 3802,  
3812, 3822, 4002, 4012,  
4022, 4202, 4212, 4222,  
4402, 4412, 4422, 4602,  
4612, 4622

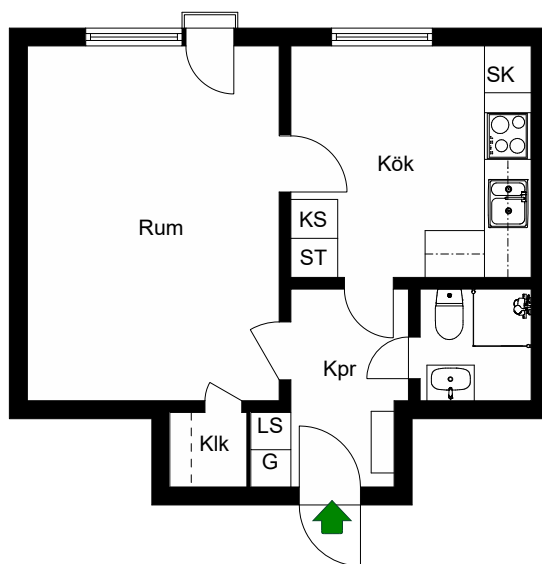

G = Garderob

Kik = Klädkammare

ST = Städskåp

[Symbol] = Dusch/Badkar

KS = Kylskåp

SK = Skafferi

LS = Linneskåp

[Symbol] = Spis

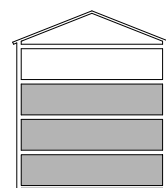
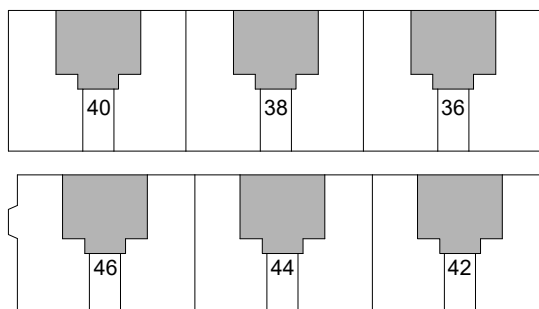



HSB – där möjligheterna bor

# ENSPÄNNARGATAN

## 36

Hässelby, Stockholm

Kv. Ekotemplet 3  
2 RoK 56 m<sup>2</sup>  
Ighnr 3603, 3613, 3623

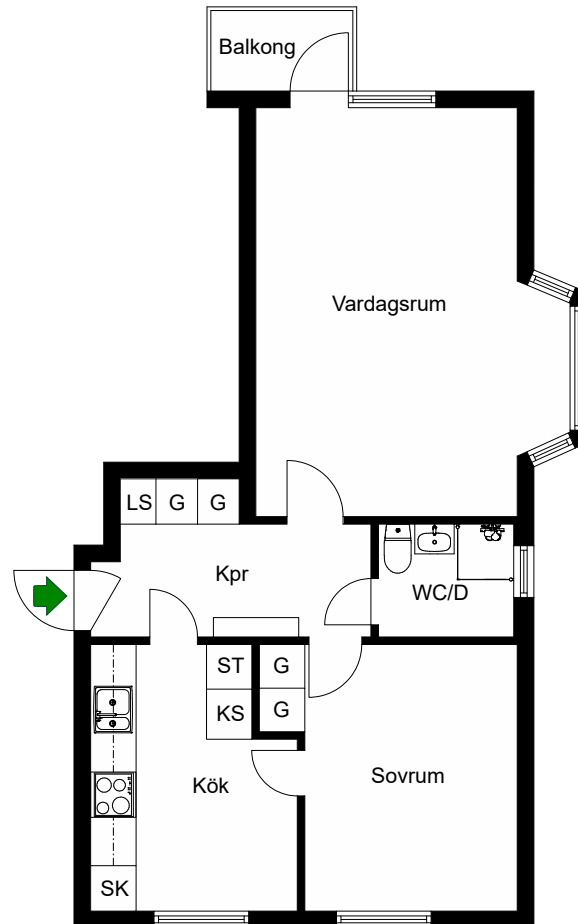

G = Garderob

= Dusch/Badkar

ST = Städskåp

KS = Kylskåp

SK = Skafferi

LS = Linneskåp

= Spis

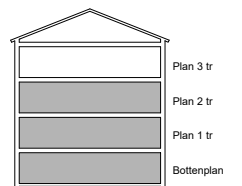
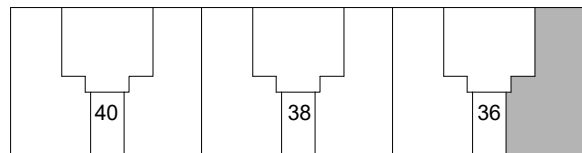

Avvikelser kan förekomma

2020-10-29



HSB – där möjligheterna bor

# ENSPÄNNARGATAN

## 38, 40, 42, 44, 46

Hässelby, Stockholm

Kv. Ekotemplet 3

2 RoK 55 m<sup>2</sup>

Ighnr 3803, 3813, 3823, 4003,  
4013, 4023, 4203, 4213,  
4223, 4403, 4413, 4423,  
4603, 4613, 4623

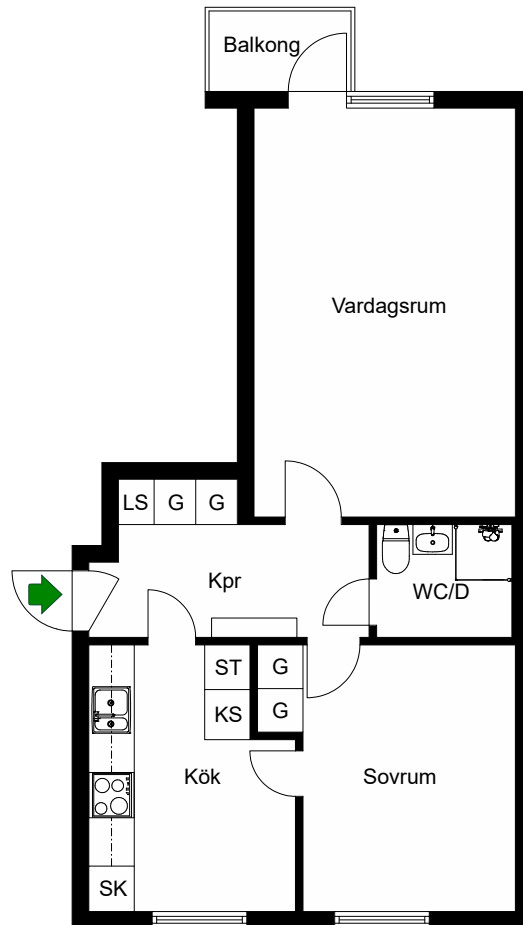

G = Garderob

= Dusch/Badkar

ST = Städskåp

KS = Kylskåp

SK = Skafferi

LS = Linneskåp

= Spis

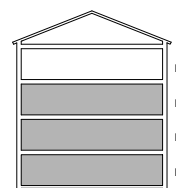
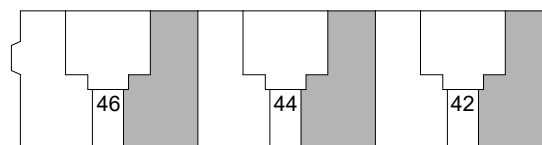
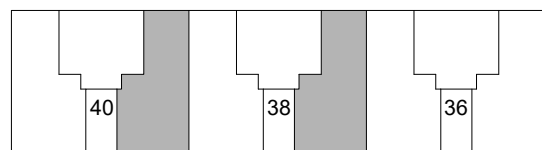

Avvikelser kan förekomma

2020-10-29



HSB – där möjligheterna bor

# ENSPÄNNARGATAN

## 40, 42, 44

Hässelby, Stockholm

Kv. Ekotemplet 3

2 RoK 55 m<sup>2</sup>

Ighnr 4001, 4011, 4021,

4201, 4211, 4221,

4401, 4411, 4421

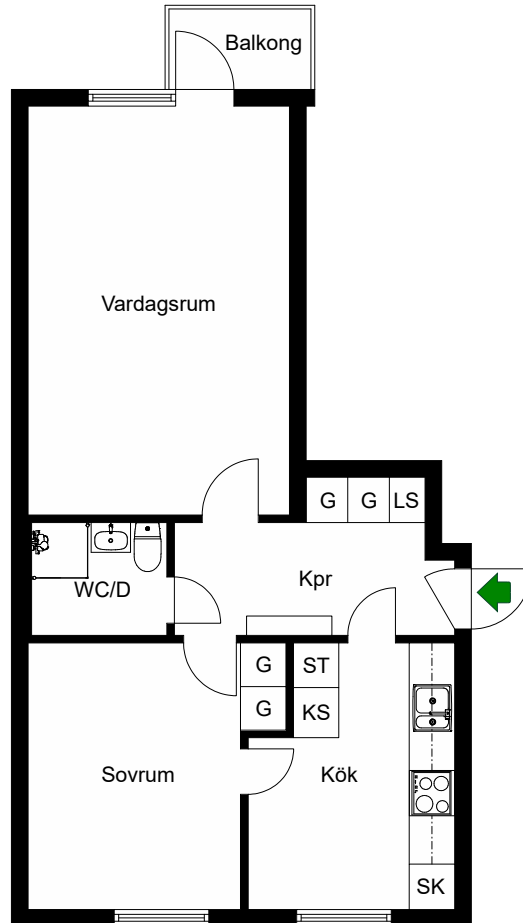

G = Garderob

= Dusch/Badkar

ST = Städskåp

KS = Kylskåp

SK = Skafferi

LS = Linneskåp

= Spis

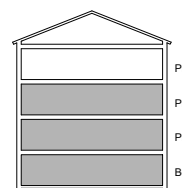
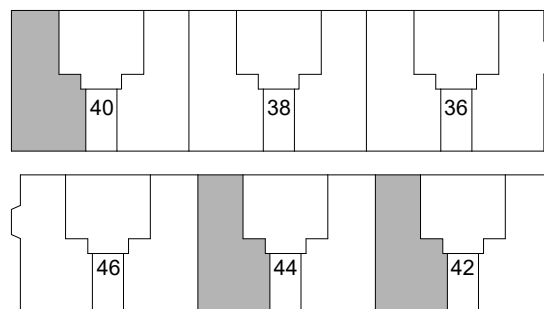

Avvikelser kan förekomma

2020-10-29



HSB – där möjligheterna bor

# ENSPÄNNARGATAN

## 46

Hässelby, Stockholm

Kv. Ekotemplet 3  
2 RoK 56 m<sup>2</sup>  
Ighnr 4601, 4611, 4621

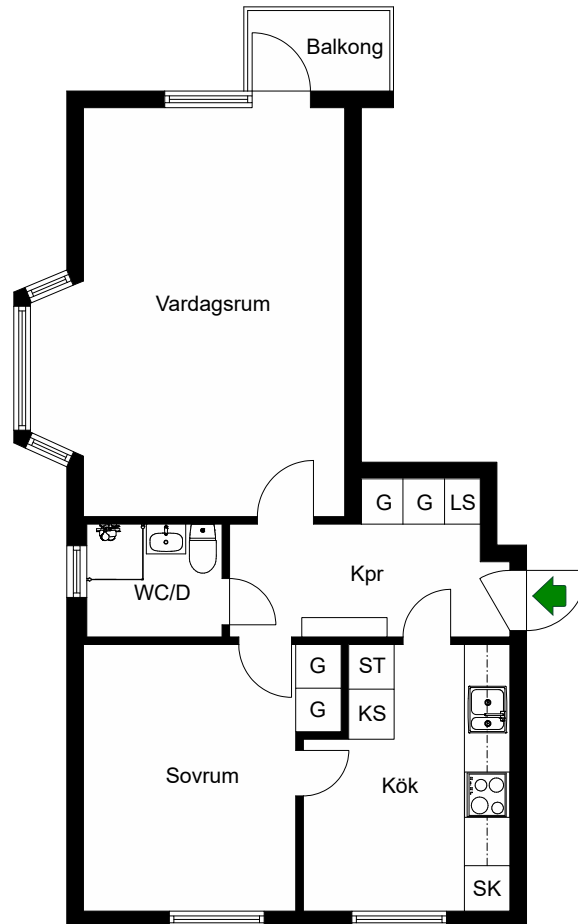

G =Garderob

=Dusch/Badkar

ST =Städsåp

KS =Kylskåp

SK =Skafferi

LS =Linneskåp

=Spis

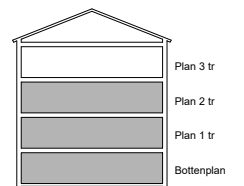
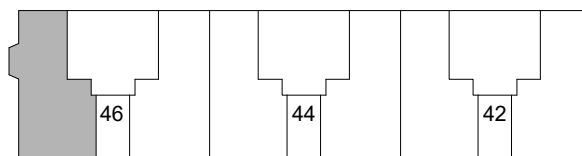

Avvikelser kan förekomma

2020-10-29



HSB – där möjligheterna bor

# ENSPÄNNARGATAN

## 52

Hässelby, Stockholm

Kv. Ekotemplet 3

4 RoK 93 m<sup>2</sup>

Ighnr 5201, 5211, 5221

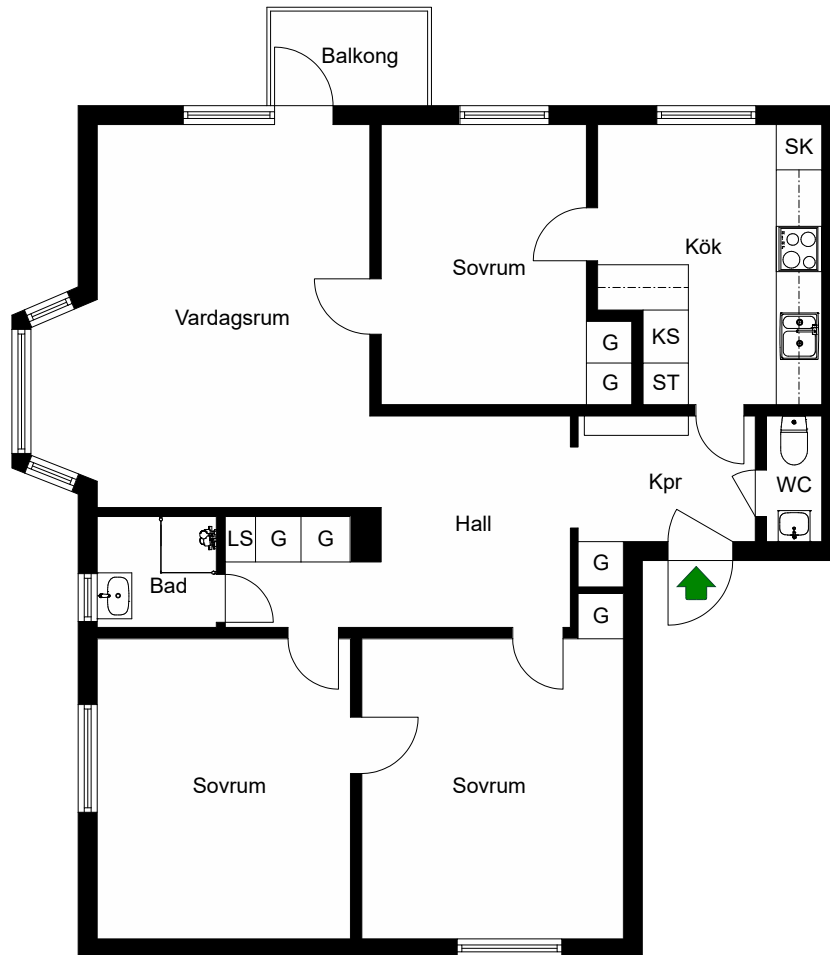

- G =Garderob
- ST =Städsåp
- KS =Kylskåp
- SK =Skafferi
- LS =Linneskåp
- ⊙ ⊙ =Spis
- ┌ =Dusch/Badkar

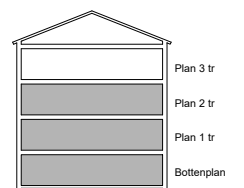
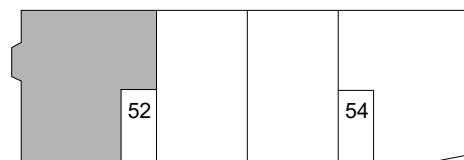

Avvikelser kan förekomma

2020-10-29



HSB – där möjligheterna bor

# ENSPÄNNARGATAN

## 52, 56

Hässelby, Stockholm

Kv. Ekotemplet 3

3 RoK 72 m<sup>2</sup>

Ighnr 5202, 5212, 5222,

5602, 5612, 5622

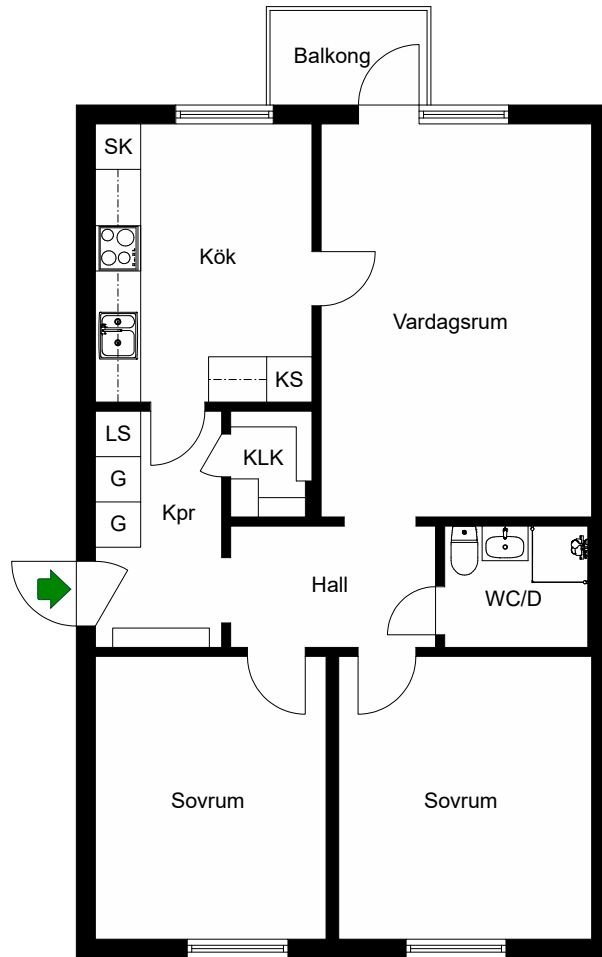

G = Garderob

KS = Kylskåp

SK = Skaffereri

LS = Linneskåp

= Spis

KIK = Klädkammare

= Dusch/Badkar

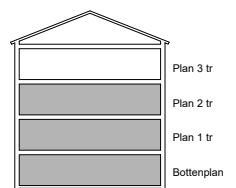

Avvikelser kan förekomma

2020-10-29



HSB – där möjligheterna bor

# ENSPÄNNARGATAN

## 54, 58, 60

Hässelby, Stockholm

Kv. Ekotemplet 3

3 RoK 72 m<sup>2</sup>

Ighnr 5401, 5411, 5421,

5801, 5811, 5821,

6001, 6011, 6021

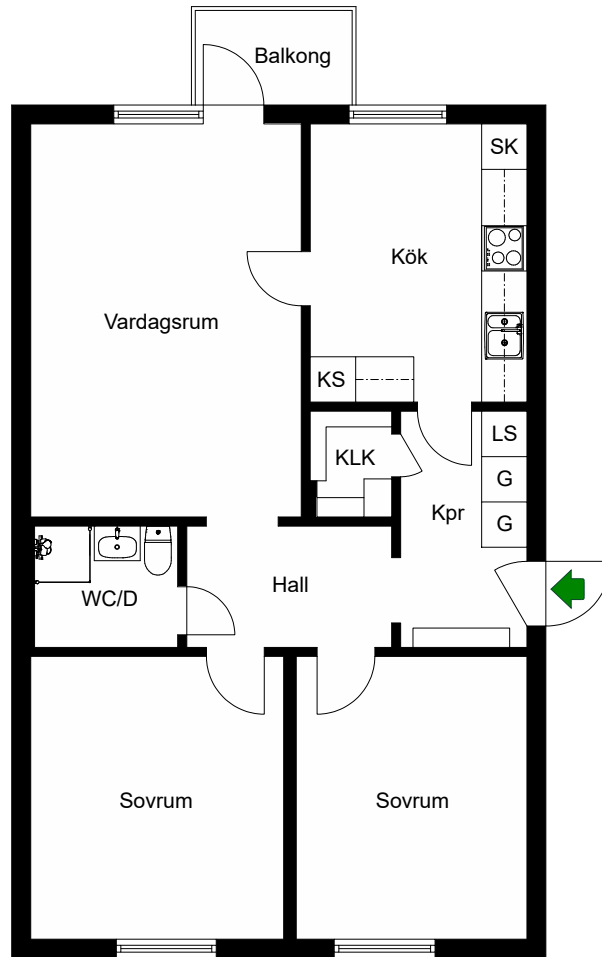

G = Garderob

KS = Kylskåp

SK = Skafferi

LS = Linneskåp

= Spis

KIK = Klädkammare

= Dusch/Badkar

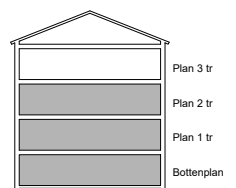

Avvikelser kan förekomma

2020-10-29





HSB – där möjligheterna bor

# ENSPÄNNARGATAN

## 54, 60

Hässelby, Stockholm

Kv. Ekotemplet 3

4 RoK 91 m<sup>2</sup>

Ighnr 5402, 5412, 5422,

6012, 6022

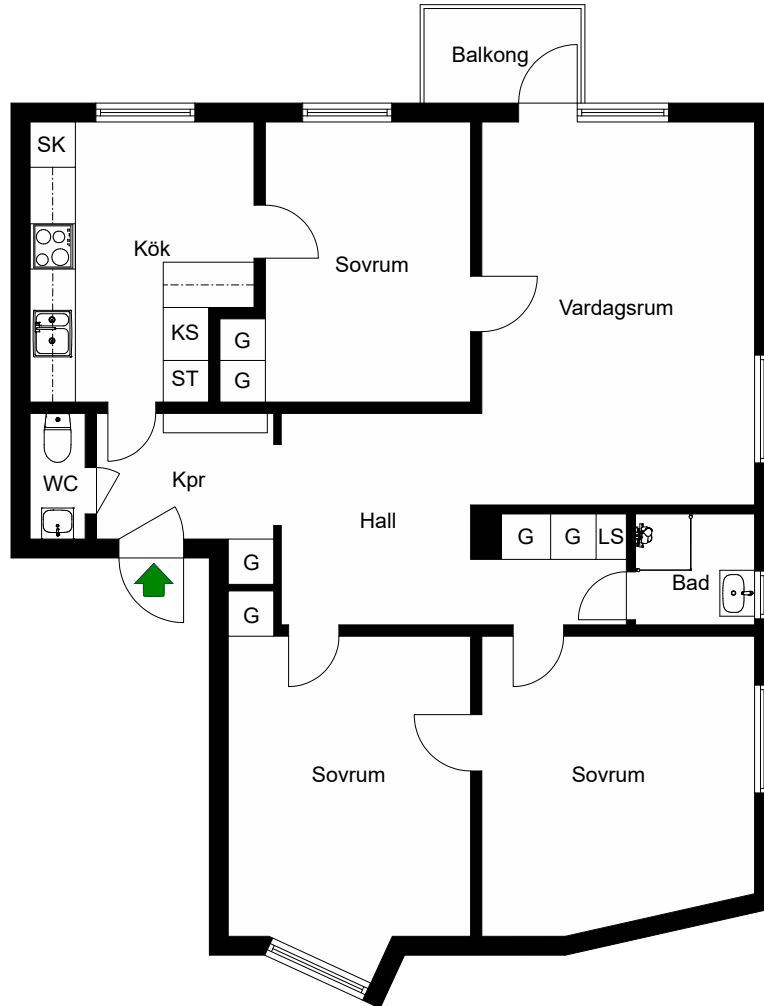

G = Garderob

└┘ = Dusch/Badkar

ST = Städskåp

KS = Kylskåp

SK = Skafferi

LS = Linneskåp

⊙ = Spis

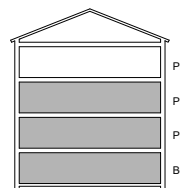

Avvikelser kan förekomma

2020-10-29



HSB – där möjligheterna bor

# ENSPÄNNARGATAN

## 56

Hässelby, Stockholm

Kv. Ekotemplet 3

4 RoK 92 m<sup>2</sup>

Ighnr 5601, 5611, 5621

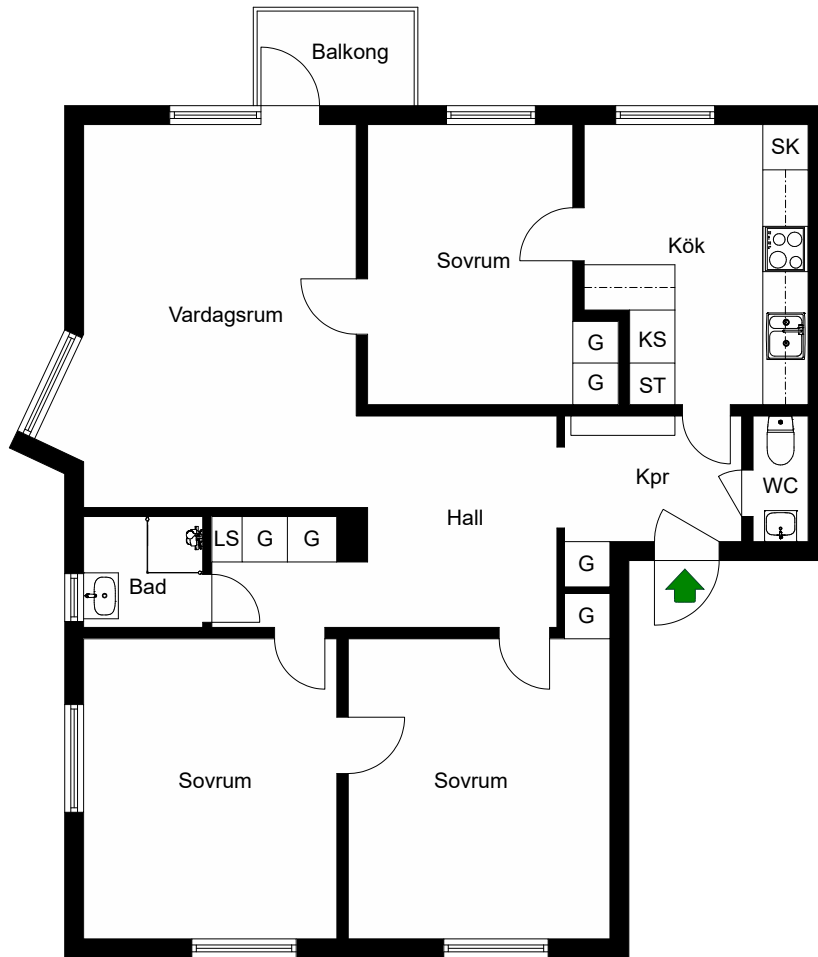

G = Garderob

└┘ = Dusch/Badkar

ST = Städsåp

KS = Kylskåp

SK = Skafferi

LS = Linneskåp

☉☉ = Spis

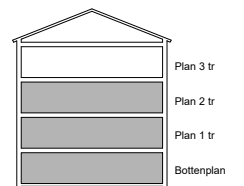
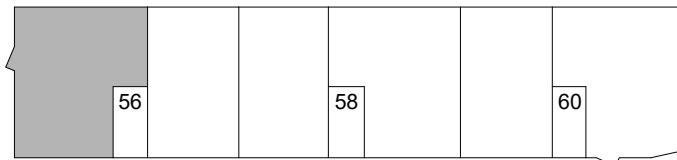

Avvikelser kan förekomma

2020-10-29



HSB – där möjligheterna bor

# ENSPÄNNARGATAN

## 58

Hässelby, Stockholm

Kv. Ekotemplet 3

4 RoK 92 m<sup>2</sup>

Ighnr 5802, 5812, 5822

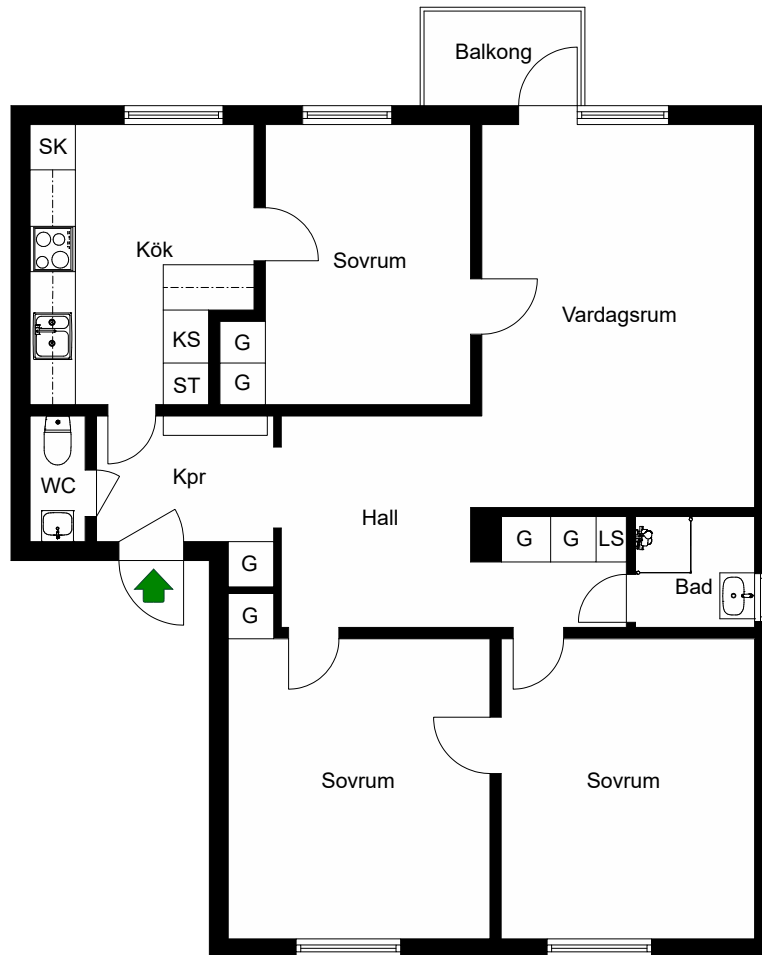

G = Garderob

└┘ = Dusch/Badkar

ST = Städskåp

KS = Kylskåp

SK = Skafferi

LS = Linneskåp

☉☉ = Spis

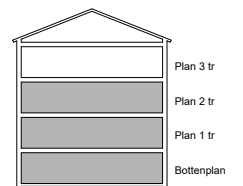
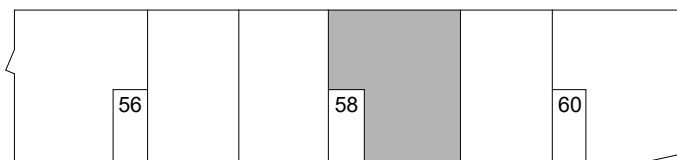

Avvikelser kan förekomma

2020-10-29



HSB – där möjligheterna bor

# ENSPÄNNARGATAN

## 60

Hässelby, Stockholm

Kv. Ekotemplet 3  
4 RoK 91 m<sup>2</sup>  
Ighnr 6002

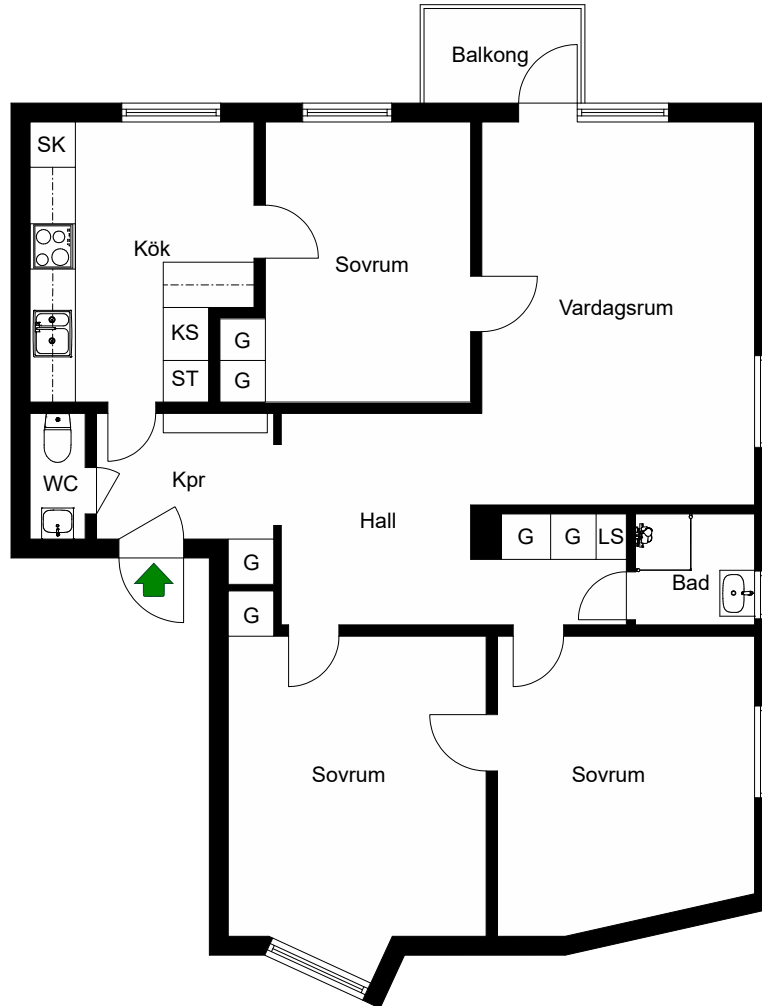

G = Garderob

└┘ = Dusch/Badkar

ST = Städskåp

KS = Kylskåp

SK = Skafferi

LS = Linneskåp

☉☉ = Spis

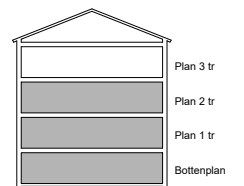
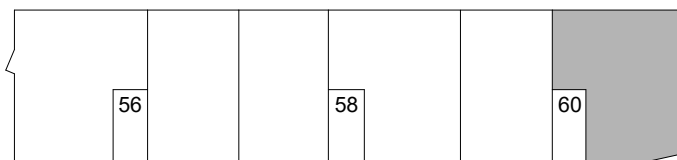

Avvikelser kan förekomma

2020-10-29



HSB – där möjligheterna bor

# ENSPÄNNARGATAN

## 62

Hässelby, Stockholm

Kv. Ekotemplet 3  
3 RoK 69 m<sup>2</sup>  
Ighnr 6201, 6211, 6221

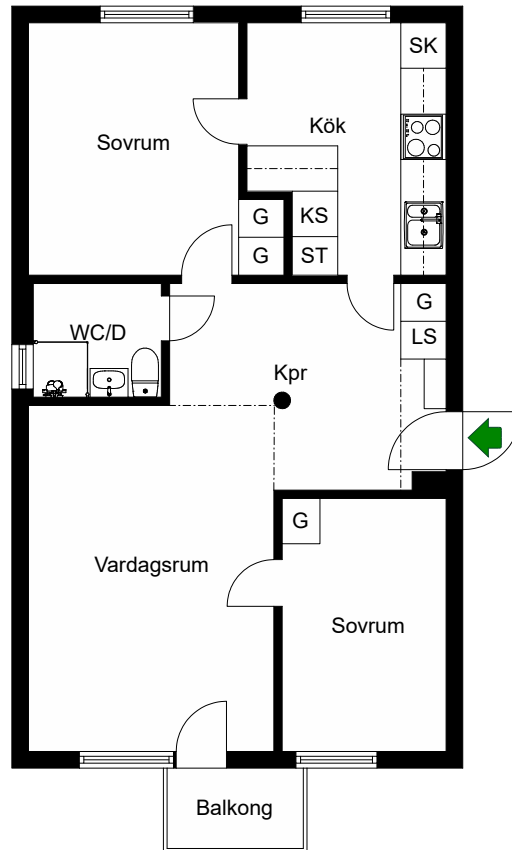

- G =Garderob
- ST =Städsåp
- KS =Kylskåp
- SK =Skafferi
- LS =Linneskåp
- ○  
○ =Spis
- =Dusch/Badkar

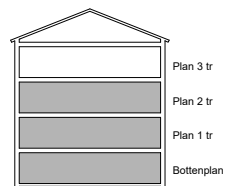
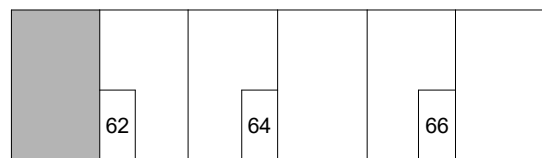

Avvikelser kan förekomma

2020-10-29



HSB – där möjligheterna bor

# ENSPÄNNARGATAN

## 62

Hässelby, Stockholm

Kv. Ekotemplet 3  
2 RoK 55 m<sup>2</sup>  
Ighnr 6202, 6212, 6222

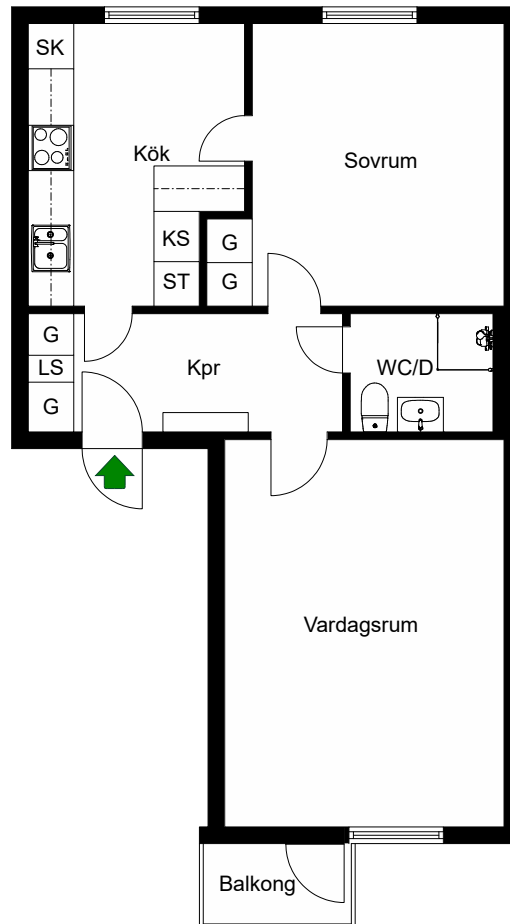

- G =Garderob
- ST =Städsåp
- KS =Kylskåp
- SK =Skafferi
- LS =Linneskåp
- ☉☉ =Spis
- └┘ =Dusch/Badkar

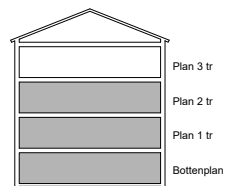
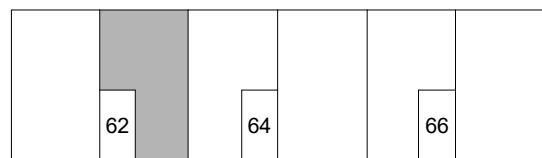

Avvikelser kan förekomma

2020-10-29



HSB – där möjligheterna bor

# ENSPÄNNARGATAN

## 64, 66

Hässelby, Stockholm

Kv. Ekotemplet 3

2 RoK 55 m<sup>2</sup>

Ighnr 6401, 6411, 6421,

6601, 6611, 6621

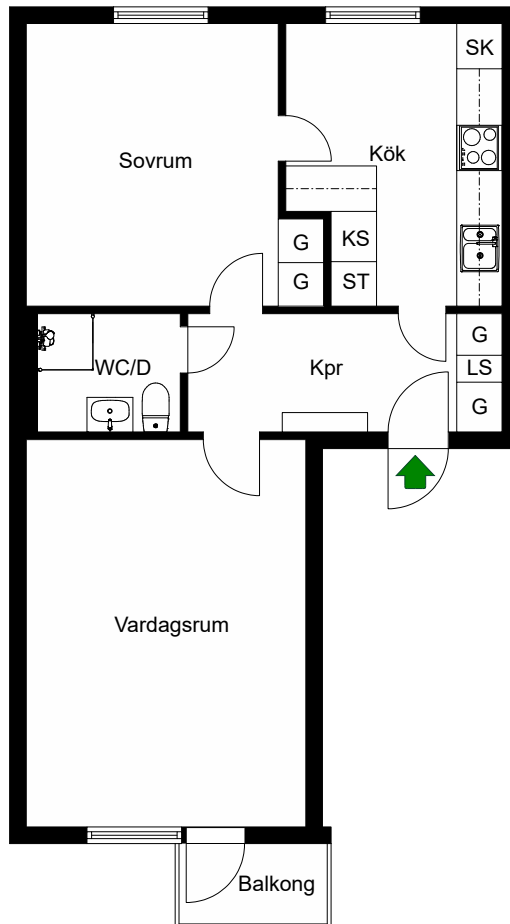

- G =Garderob
- ST =Städsåp
- KS =Kylskåp
- SK =Skafferi
- LS =Linneskåp
- =Spis
- =Dusch/Badkar

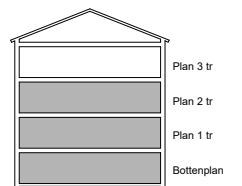
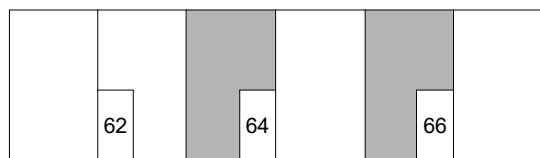

Avvikelser kan förekomma

2020-10-29



HSB – där möjligheterna bor

# ENSPÄNNARGATAN

## 64

Hässelby, Stockholm

Kv. Ekotemplet 3  
3 RoK 69 m<sup>2</sup>  
Ighnr 6402, 6412, 6422

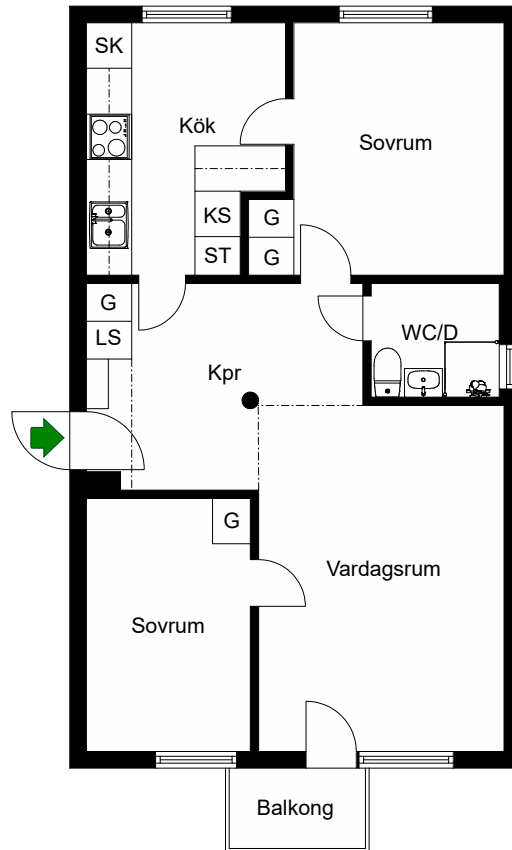

- G =Garderob
- ST =Städsåp
- KS =Kylskåp
- SK =Skafferi
- LS =Linneskåp
- ☉☉ =Spis
- L =Dusch/Badkar

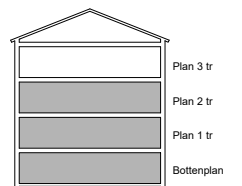
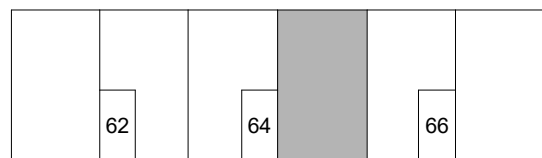





HSB – där möjligheterna bor

# ENSPÄNNARGATAN

## 66

Hässelby, Stockholm

Kv. Ekotemplet 3  
3 RoK 71 m<sup>2</sup>  
Ighnr 6602, 6612, 6622

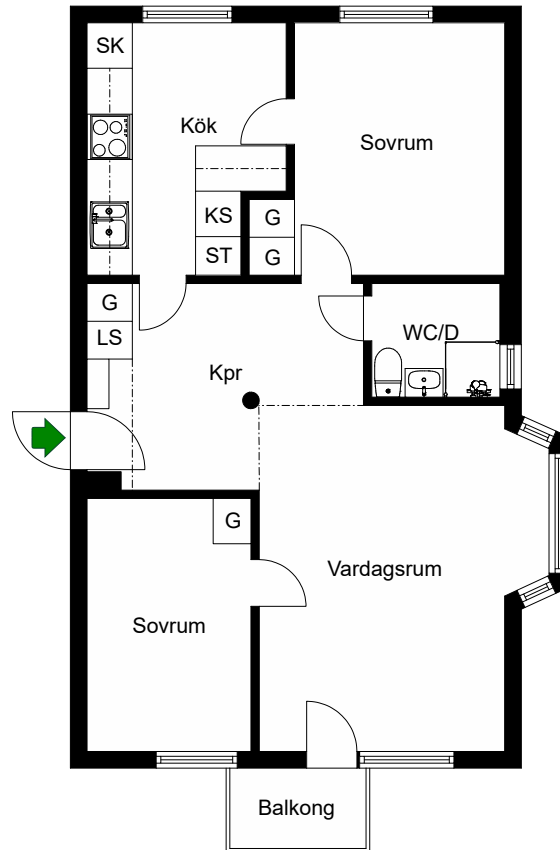

- = Garderob
- = Städskåp
- = Kylskåp
- = Skafferi
- = Linneskåp
- = Spis
- = Dusch/Badkar

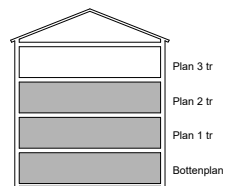
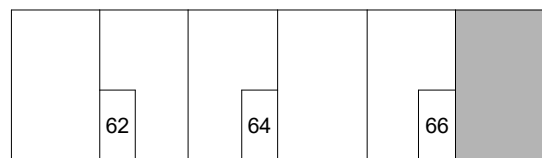

Avvikelser kan förekomma

2020-10-29