



HSB – där möjligheterna bor

LUNDAGATAN 49-55

Södermalm, Stockholm

Kv. Sparren 10
1 RoK 26 m²

Ighnr 1001, 1009, 1017, 1025,
1033, 1041, 1049, 1062, 1070,
1078, 1086, 1094, 1102, 1110,
1118, 1126, 1134, 1142, 1150,
1158, 1166, 1174, 1182

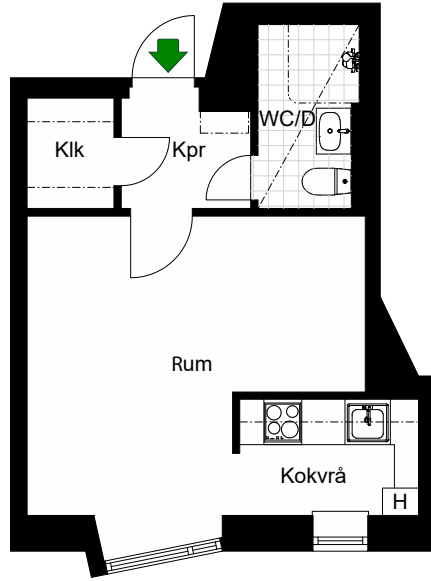

H =Högskap

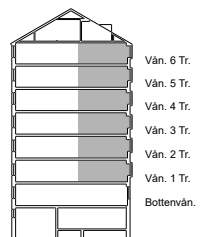
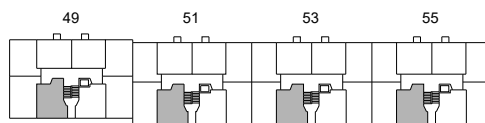

Avvikelser kan förekomma

2019-09-23



HSB – där möjligheterna bor

LUNDAGATAN 49-55

Södermalm, Stockholm

Kv. Sparren 10
1 RoK 30 m²

Ighnr 1002, 1010, 1018, 1026,
1034, 1042, 1050, 1063, 1071,
1079, 1087, 1095, 1103, 1111,
1119, 1127, 1135, 1143, 1151,
1159, 1167, 1175, 1183

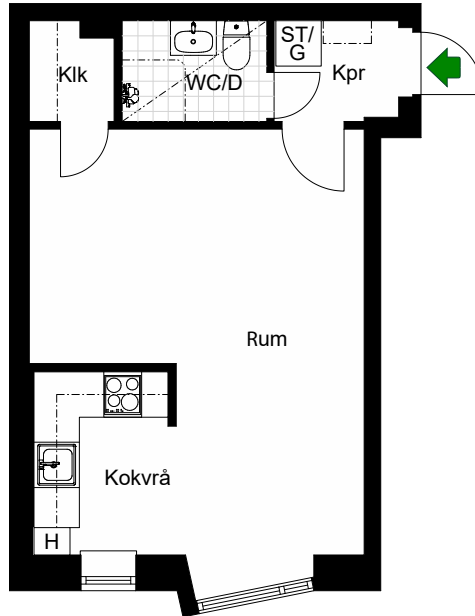

ST/G = Städsåp/Garderob

H = Högskåp

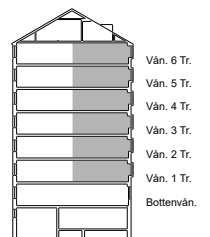
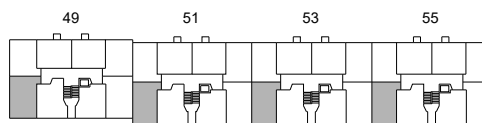

Avvikelser kan förekomma

2019-09-23



HSB – där möjligheterna bor

LUNDAGATAN 49-55

Södermalm, Stockholm

Kv. Sparren 10
1 RoK 26 m²

Ighnr 1003, 1011, 1019, 1027,
1035, 1043, 1051, 1064, 1072,
1080, 1088, 1096, 1104, 1112,
1120, 1128, 1136, 1144, 1152,
1160, 1168, 1176, 1184

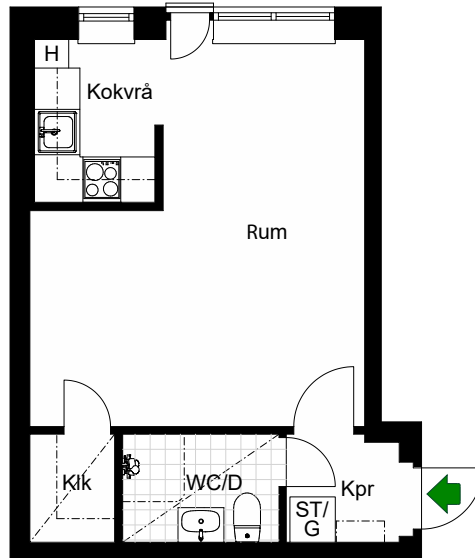

 = Städsåp/Garderob

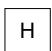
 = Högskåp

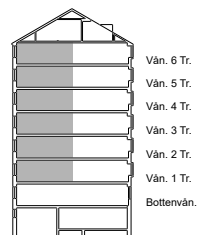
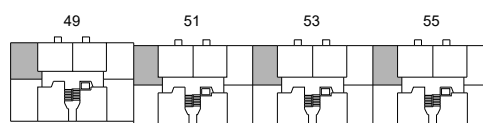

Avvikelser kan förekomma

2019-09-23



HSB – där möjligheterna bor

LUNDAGATAN 49-55

Södermalm, Stockholm

Kv. Sparren 10
1 RoK 24 m²

Ighnr 1004, 1012, 1020, 1028,
1036, 1044, 1052, 1065, 1073,
1081, 1089, 1097, 1105, 1113,
1121, 1129, 1137, 1145, 1153,
1161, 1169, 1177, 1185

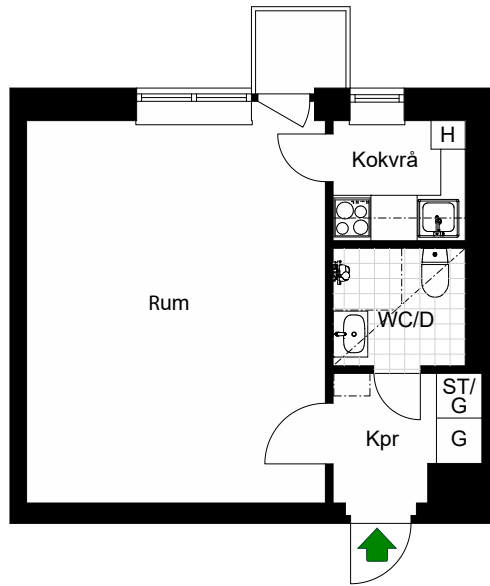

ST/G = Städsåp/Garderob

H = Högskåp

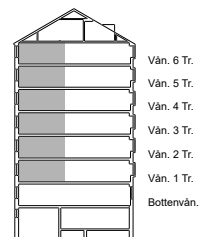
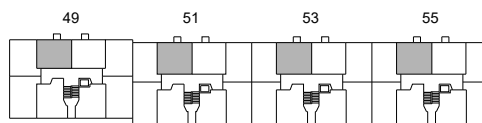

Avvikelser kan förekomma

2019-09-23



HSB – där möjligheterna bor

LUNDAGATAN 49-55

Södermalm, Stockholm

Kv. Sparren 10
1 RoK 24 m²

Ighnr 1005, 1013, 1021, 1029,
1037, 1045, 1053, 1058, 1066,
1074, 1082, 1090, 1106, 1114,
1122, 1130, 1138, 1154, 1162,
1170, 1178, 1186

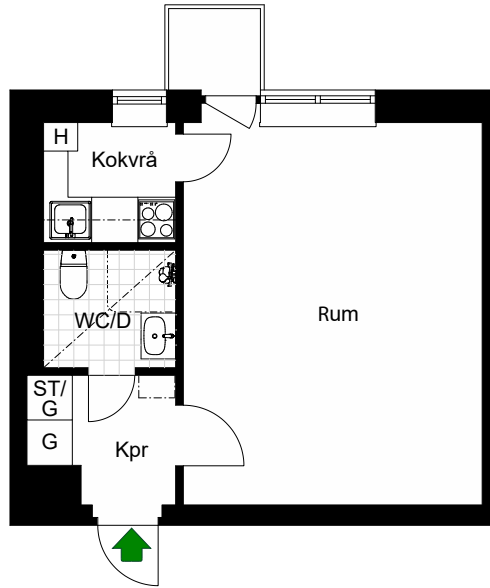

ST/G = Städsåp/Garderob

H = Högskåp

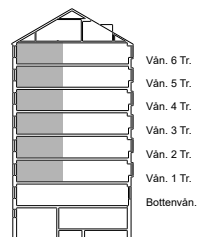
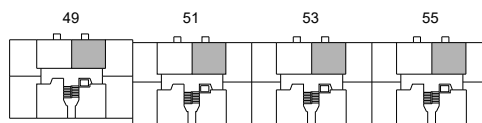

Avvikelser kan förekomma

2019-09-23



HSB – där möjligheterna bor

LUNDAGATAN 49-55

Södermalm, Stockholm

Kv. Sparren 10
1 RoK 26 m²

Ighnr 1006, 1014, 1022, 1030,
1038, 1046, 1054, 1059, 1067,
1075, 1083, 1091, 1107, 1115,
1123, 1131, 1139, 1155, 1163,
1171, 1179, 1188

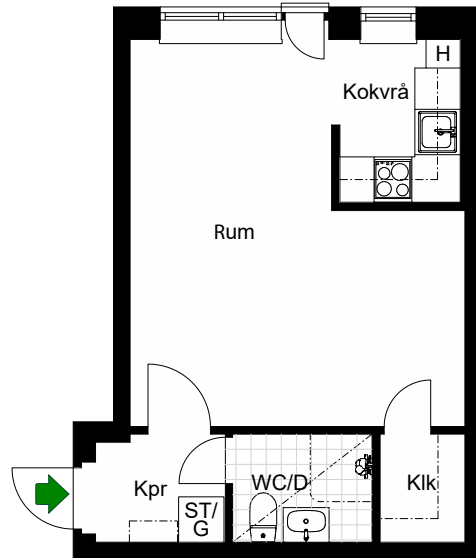

 = Städsåp/Garderob

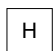
 = Högskåp

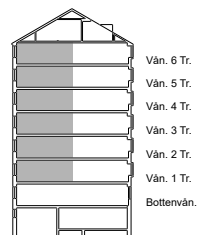
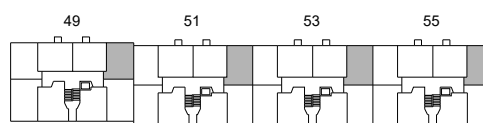

Avvikelser kan förekomma

2019-09-23



HSB – där möjligheterna bor

LUNDAGATAN 49-55

Södermalm, Stockholm

Kv. Sparren 10
1 RoK 30 m²

Ighnr 1007, 1015, 1023, 1031,
1039, 1047, 1055, 1060, 1068,
1076, 1084, 1092, 1100, 1108,
1116, 1124, 1132, 1140, 1148,
1156, 1164, 1172, 1180, 1189

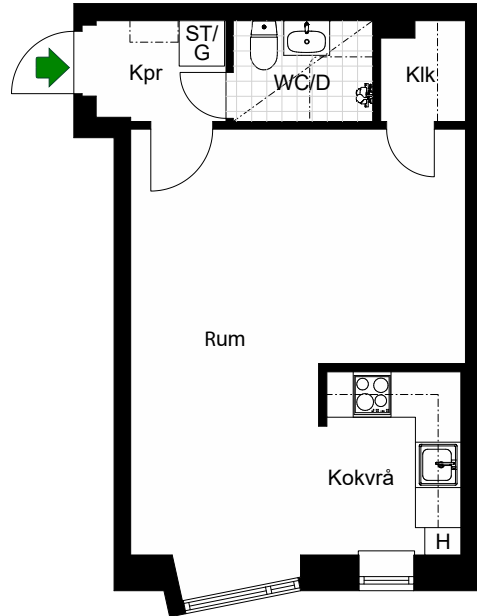

ST/G = Städsåp/Garderob

H = Högskåp

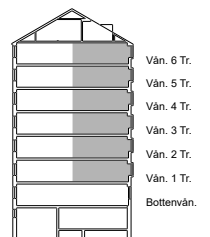
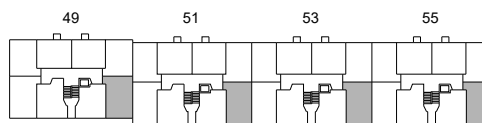



HSB – där möjligheterna bor

LUNDAGATAN 49-55

Södermalm, Stockholm

Kv. Sparren 10
1 RoK 24 m²

Ighnr 1008, 1016, 1024, 1032,
1040, 1048, 1056, 1061, 1069,
1077, 1085, 1093, 1101, 1109,
1117, 1125, 1133, 1141, 1149,
1157, 1165, 1173, 1181, 1190

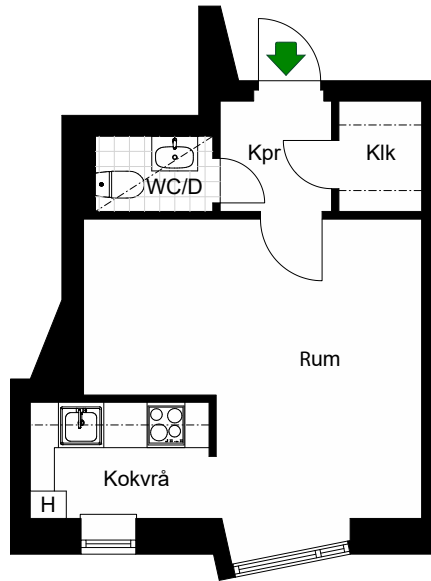

H =Högskåp

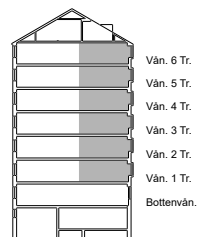
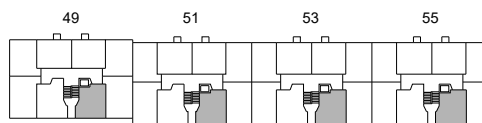

Avvikelser kan förekomma

2019-09-23



HSB – där möjligheterna bor

LUNDAGATAN 49-55

Södermalm, Stockholm

Kv. Sparren 10
2 RoK 58 m²
Ighnr 1057

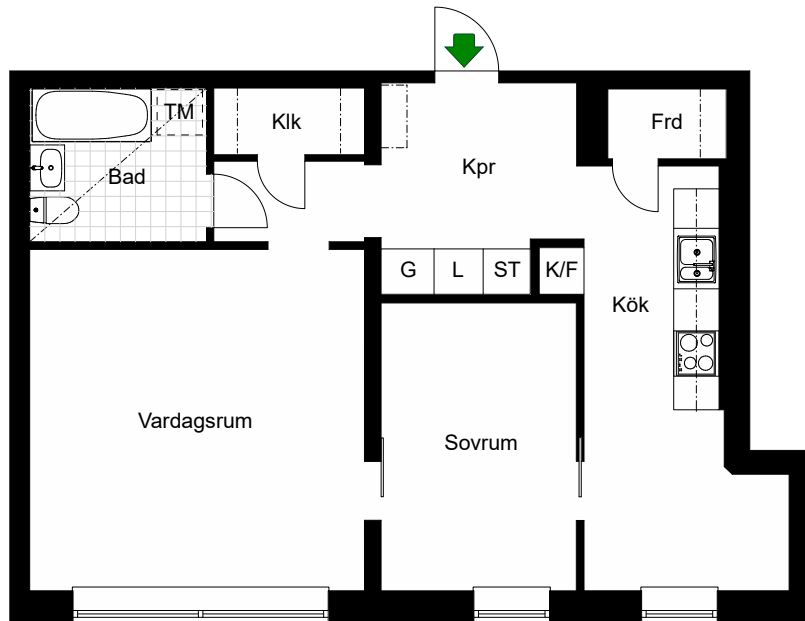

- G =Garderob
- K/F =Kyl & Frys
- L =Linneskåp
- ST =Städsåp
- TM =Plats för tvättmaskin

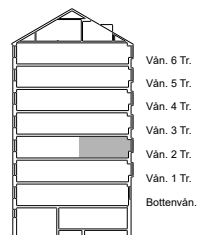
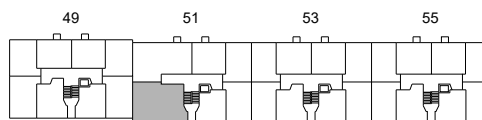

Avvikelser kan förekomma

2019-09-23



HSB – där möjligheterna bor

LUNDAGATAN 49-55

Södermalm, Stockholm

Kv. Sparren 10
2 RoK 58 m²
Ighnr 1099

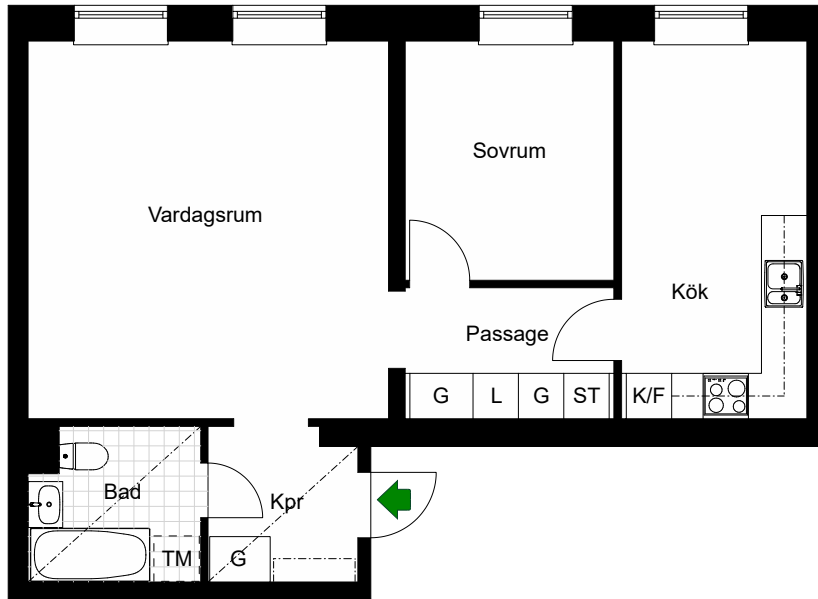

- G =Garderob
- K/F =Kyl & Frys
- L =Linneskåp
- ST =Städsåp
- TM =Plats för tvättmaskin

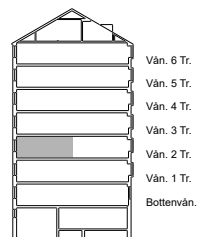
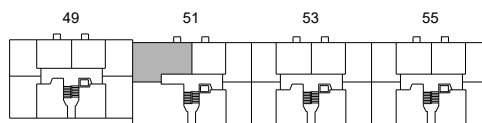

Avvikelser kan förekomma

2019-09-23



LUNDAGATAN 49-55

Södermalm, Stockholm

Kv. Sparren 10
2 RoK 56 m²
Ighnr 1098

HSB – där möjligheterna bor

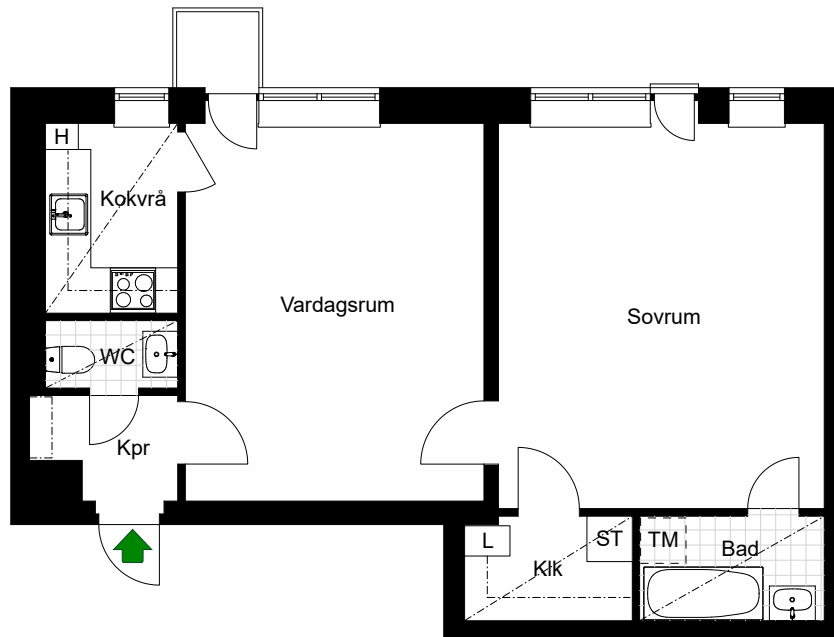

- H = Högsåp
- L = Linnesåp
- ST = Stådsåp
- TM = Plats för tvåttmaskin

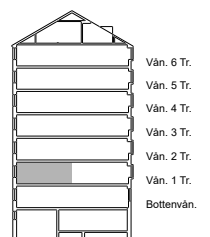
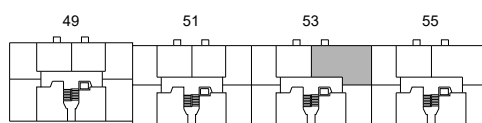

Avvikelser kan förekomma

2019-09-23



HSB – där möjligheterna bor

LUNDAGATAN 49-55

Södermalm, Stockholm

Kv. Sparren 10
2 RoK 56 m²
Ighnr 1146

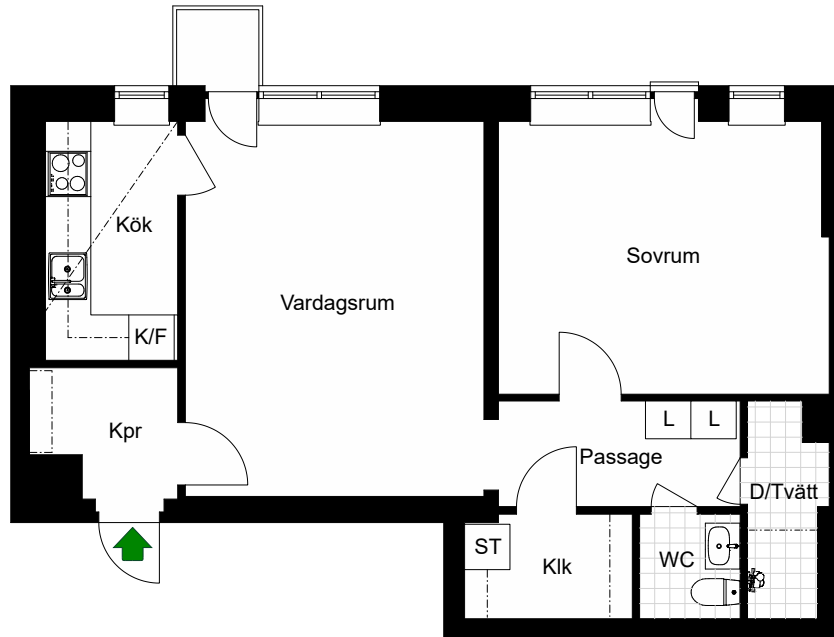

K/F =Kyl & Frys

L =Linneskåp

ST =Städsåp

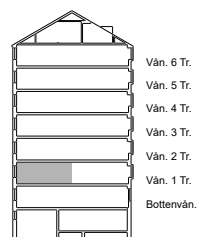
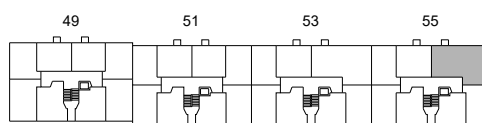

Avvikelser kan förekomma

2019-09-23